

Hi Elias from the team at DeLuxe RV Group



In this months newsletter

- Intro
- Deluxe RV Group News
- Great Weekend Destinations: Wellington
- Pilote Update: Discover The All New Atlas
- Hamilton Motorhome Show Review
- Staff Trip: Queenstown
- How to Article: Pioneer Multimedia Head Unit
- Le Voyageur Update: LV Eterna Replacing LV Classic
- Customer Story: Grant and Marion



Welcome to the October issue of the Deluxe RV Group Newsletter!

The last couple of months have been busy for us here at Deluxe RV and everyone is getting excited about the longer days and warmer weather.

Daryl and his family have been on a trip around the South Island, Matt is currently heading to the USA via the Gold Coast, Colin, Brett, and Jesse are booked in for holidays in the coming weeks and I will take some time off soon when Matt has returned. It's a great time of the year to spend a few days on the road and re-energise before the usual busy month of December.

Please refer to the "Deluxe RV Group News" for our Christmas dates and ensure you book in as early as possible if you require a workshop booking.

Enjoy the read and have a great start to the warmer season!!!

Deluxe RV Group News



Brett and his team keep the workshop immaculate and take pride in what they do.

We have recently decided to tidy it up by lining the walls and the boys have done a great job.

The Team at Deluxe will be taking a well-deserved break during the festive season. Please refer to the opening dates below and note that we will commence vehicle handovers on the 08th of January 2024.

We thank you for your understanding and please feel free to contact us for any further questions.

22nd December 2023 - 3rd January 2024

Christmas Holidays - Deluxe RV Group Office Closed

22nd December 2023 - 08th January 2024

Christmas Holidays - Deluxe RV Group Workshop Closed

Great Weekend Destinations: Wellington



We are moving across the Cook Strait to our first North Island weekend destination Wellington.

"Situated at the southern end of the North Island and nestled between green hills and a sparkling harbour, Wellington, New Zealand, is a little city with a big heart."

Poppy and I have always enjoyed Wellington and can only recommend the city as a weekend destination to anyone who is keen to explore it.



"Discover Wellington

Surrounded by nature and fuelled by creative energy, Wellington is a compact city with a powerful mix of culture, history, nature and cuisine.

Wander through hidden laneways to discover street art and follow the sculpture walks along Wellington's waterfront. Discover the stories of Aotearoa New Zealand in world-class museums and galleries – the interactive and immersive national museum, Te Papa, is a must-visit. Ride the iconic Wellington Cable Car for amazing views of the city while you enjoy an ice cream at the top.

Immerse yourself in nature and explore by bike, foot, kayak, or ferry. Relax at Oriental Bay, Wellington's golden-sand inner-city beach, before walking the Southern Walkway trail to Wellington's rugged south coast. Venture north to explore the Remutaka Cycle Trail, one of New Zealand's Great Rides, or the Escarpment Track, where you can experience spectacular views of the Kāpiti Coast as you scale steep steps, ridgelines, and swing bridges."



Te Papa Museum

Te Papa is the largest museum in the country and a must visit when exploring Wellington. Whether you want to visit it for few hours or a whole day, the museum never disappoints.

<https://www.tepapa.govt.nz/>

Wellington Cable Car

No trip to Wellington is complete without a quick historic journey on the Cable Car. Enjoy the best views at the Kelburn Lookout. Easy access to the Botanic Garden, Cable Car Museum, Space Place (Carter Observatory) and Zealandia (via free shuttle).

<https://www.newzealand.com/nz/plan/business/wellington-cable-car/>



Remutaka-Cycle-Trail

Get to know the wild side of Wellington and the Wairarapa on this Great Ride around the Remutaka Ranges and Pacific Ocean coast.

<https://www.newzealand.com/nz/feature/remutaka-cycle-trail/>

Wētā Workshop Experience

Dive head-first into a world of creativity, physical effects and movie magic at Wētā Workshop in Wellington.

<https://www.newzealand.com/nz/plan/business/weta-studio-tours-combo/>



Pilote Update: Discover The All New Atlas

"Discover the latest Pilote motorhome, specially designed for modern adventurers. With its unique adventurous look, this compact vehicle on a Ford Transit chassis offers the perfect combination of style and performance. Ready to take on any terrain, it will allow you to set off on your adventure with confidence, giving you the comfort and freedom you need to explore new horizons. Whether you're a keen hiker or a wilderness explorer, the Pilote motorhome is your ideal companion for unforgettable adventures."



We are anticipating the arrival of the first Atlas Motorhome in 2024 and are excited to see a modern Pilote motorhome based on a Ford platform. I recently came across a German review of the 2023/2024 Pilote Atlas A696G and I am stoked to share some detailed information with you as we will be importing this exact model.

I believe that the specifications will be very similar to the NZ model however please be aware that specifications may vary and are subject to change. Enjoy the read and please feel free to email me if you have any further questions!!!

"Upscale amenities at no additional cost"

The series is based on the Transit Trail, whose radiator grille with massive Ford lettering indicates the automatic limited-slip differential. Black aluminum rims and an awning in the same color are available as standard - like so many other things, from the solar system to the satellite system. This puts the targeted price into perspective, especially since the basic vehicle equipment with numerous

extras, reversing camera and 170hp engine including automatic transmission is impressive.

Length: 6.98m Long - 2.20m Wide - 2.88m High

GVM: 3550KG

Berths: 4

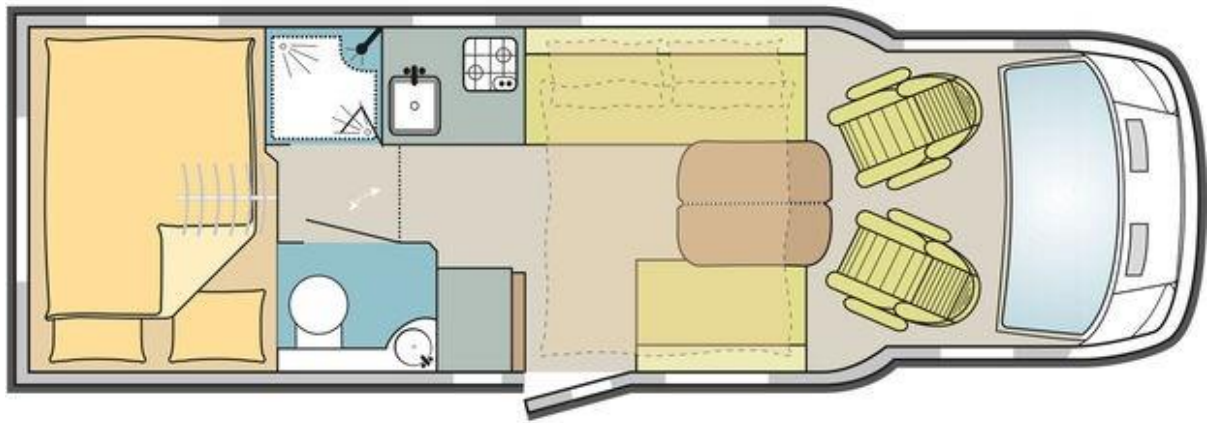

Above: The comfortable seating area has benches measuring 1.0m and 1.54m in length. The table is stable and is sufficiently large at 90 x 82 cm.

Headroom under the fold-down bed: 1.93m.

You enter the living room via the electric step through a comparatively narrow door (50 cm). To the right of it is the large seating area with two longitudinal benches. They come in lengths of 1.0m and 1.54m and so four people can sit comfortably at the large, stable table without turning the driver's cab seats. The solid furniture construction in light colors with dark upholstery as a contrast, in addition to the good headroom - 2.08m, 1.93m under the fold-down bed - ensures an airy feeling of space in the Atlas. Large campers still have to be careful, as there are open shelves at the bottom of the fold-down bed right next to the body door; It's easy to hit your head when you close the door from the inside.



Above: The 1.90 m x 1.40 m fold-down bed can be electrically lowered to 81 cm. The mattress lies on slatted frames.

The drop down bed over the lounge is a handy additional sleeping space and would suit young families.



Above: Discover the well-equipped kitchen of the A696G Pilote camping car, designed to satisfy all food lovers on the go. With its spacious 133 litre refrigerator, you can easily store your fresh food and favorite beverages. The multiple intelligent storage options provide a practical solution to organise your cooking utensils and supplies, making it easy to prepare delicious meals with ease.



Behind the kitchen is the bathroom, which has a step leading up to it. This means that the headroom in the sanitary area is limited to 1.91 m (shower 1.92 m). The reason for the floor platform is, among other things, the waste water tank, which is installed underneath in a frost-proof manner and whose wide-mouth opening can be reached through a floor flap in the bathroom. The equipment is complete and easy to use. Light and air can reach the sanitary area via two roof hoods. The bathroom can be separated from the living room with a door. There is no separation from the rear bed.



The rear bed is reached via a step in the narrow, 66 centimeter wide entrance. The transverse double bed is impressive with a length of 2.10m, but the mattress stored on slatted frames is only 1.31m wide - that's more like campervan level . The large rear window provides unusual views. The roller curtain hanging in front of it can also be used as a privacy screen instead of the folding blind. This is particularly practical when the outside temperature is warm, as a draft can still blow through the vehicle when the window is open.



With a width of 85cm and a height of 1.11m, it is suitable for two standard bicycles. Two garage doors are standard and two car-wide lashing rails with sliding eyelets are used to secure loads. On the right side of the garage there is also an outdoor shower with cold and hot water, which is also included in the basic price.

Specifications:

Permanent East-West Bed with Drop Down Double, 4 Berth, Separate Shower and Toilet, 2 Gas Hobbs with Oven, Automatic Fridge/Freezer, Truma Combi 4KW Heating and Hot Water, 130l Fresh and 90l Grey Water Tanks, Space for 2x 9KG Gas Bottles, 6.98m Long - 2.20m Wide - 2.88m High, 3.95m Wheelbase, 3550KG GVM, 170HP Turbo Diesel Engine, Cruise Control, 2x 100w Solar Panels, Outdoor Shower, Frost Proof Waste Water Tank, Awning, Reversing Camera, Multimedia Screen, Crash Sensitive Truma Regulator, Collision Warning, Lane Departure Warning, Black Aluminum Rims

Hamilton Motorhome Show Review



This year's NZMCA Motorhome, Caravan and Leisure Show in Hamilton was a lot of fun. None of us really knew what to expect considering current uncertainties in business and the economy. However, we were pleasantly surprised with Friday's turnout and the general positive vibe from visitors.



The show started with a strong first day and numbers slowly declined towards the end of the event. The general consensus is that the event went well, and exhibitors had a great time, however we did see visitor levels and sales drop back down to pre-Covid levels.

It will be very interesting to see how our much-loved RV industry develops in the near future and we can't wait to be part of it all!!!



Staff Trip: Queenstown



Daryl, Linda, Carter and the two dogs ventured south for a recent motorhome holiday. Leaving Blenheim travelling south on one coast all the way to Queenstown and travelling up the other coast has become a bit of a family tradition and a go-to South Island Trip.

There is definitely something about revisiting a well known route and catching up with friends and family along the way.

All in all, the trip was a great success. Daryl did mention that there were quite a few more tourists on the roads and places are starting to get busier. I say make the most of Spring and get out there before everyone else has the same idea.





How to Article: Pioneer Multimedia Head Unit



Technology is an ever-advancing minefield and seems to change and update quicker than anyone can keep up with. Last year the Fiat cab had a major update and Pilote has started to use a new Pioneer Head Unit. I personally fell in love with how easy and simple the system is however it looks like a slightly different version of the unit is being fitted to our brand-new campers. Watch this space!!!

<https://youtu.be/mLcFS73C2HU>

Le Voyageur Update: LV Eterna



"Are you looking for a luxury motorhome? With a refined layout, high quality finishes, aerodynamics serving driver comfort and faultless road handling. Nothing has been forgotten in the Le Voyageur motorhomes.

Because the exception must serve to prove the rule for as many people as possible, discover the Le Voyageur motorhomes."

Such a true statement. We absolutely love our Le Voyageur Motorhomes and the introduction of the Heritage Range in 2022 was a full success. In 2024 the Le Voyageur Eterna Range will replace the Classic and that comes with a few changes to the design and build of the motorhome. We are anticipating the arrival of new Eterna's for the upcoming season and can't wait to premier the first one in New Zealand.



ALKO Chassis Update (ALKO STC Chassis):

The new chassis will be completely flat, and the stringers will be lowered from 215mm to 122mm aligning them with the rest of the platform. This will result in a 90mm gain in the double floor storage, allow for more storage, and create a better driving comfort due to the lower center of gravity.



Exterior:

Le Voyageur is also updating the rear side, introducing new skirt lines and fog lights, updating the front side and bonnet design, and removing the curved dome roof to align the design with the Heritage model.



Interior:

The LV Eterna showcases the same level of quality finish whilst the design has been updated to a clean and simple approach. It will be interesting to see which one people prefer.

Customer Story: Grant and Marion





Grant and Marion decided to take their Le Voyageur Classic motorhome down south and try their luck at canal fishing. I had a chance to catch up with them when they returned to Blenheim and being a keen fisherman myself, I am always very excited to hear of anyone's angling adventures.

Great to see customers enjoying fishing in comfort and style!!!





If you have an interest in anything contained within our Newsletter then please don't hesitate to contact us, we would love to hear from you.

From Elias and the team at DeLuxe RV Group.

Email: elias@deluxegroup.co.nz

Phone: (03) 578 3310

Web: www.deluxegroup.co.nz

45 Main Street, Blenheim

[Unsubscribe](#)

DeLuxe Group P O Box 749 Blenheim 7240 New Zealand 6435783310