



GO WITH  
THE NATION'S  
FAVOURITE

Caravans 2023







WHERE  
NEXT?



## Welcome to Bailey, The Nation's Favourite.

We've been proudly hitting the road for over 75 years. Along the way, we've built hundreds of thousands of Bailey caravans and motorhomes, each of them made with one thing in mind: creating the perfect holiday.

So, no matter which of our models you choose for your home away from home; comfort, convenience and adventure are built into every one.

**GO BAILEY!** We can't wait to see you out there.

### Contents

Bailey heritage	02	Alicanto Grande	10
Sustainability	03	Pegasus Grande SE	16
Made in Bristol	04	Unicorn	24
Tested to the limit	06	Phoenix+	32
Choose your Bailey	08	Discovery	40
		Where to buy	46
		Bailey Owners Club	47
		PRIMA accessories	48



# Bailey by name...

The Bailey story started back in 1947, when Martin Bailey designed and built the very first Bailey caravan in his South Bristol garage. A year later in 1948, F G Bailey Ltd was formed and their caravans captured the nation's growing quest for adventure. Bailey quickly grew into the thriving, family-run business it still is today.

We've come a long way since those early days, but even with 75 years of experience now behind us, we have never stopped considering how we can push the boundaries and make our business better. And, like you, we continue to look towards to our next adventure...

To learn more about our history and heritage, visit our '75 Years and Counting' page on the Bailey website or scan the QR below.

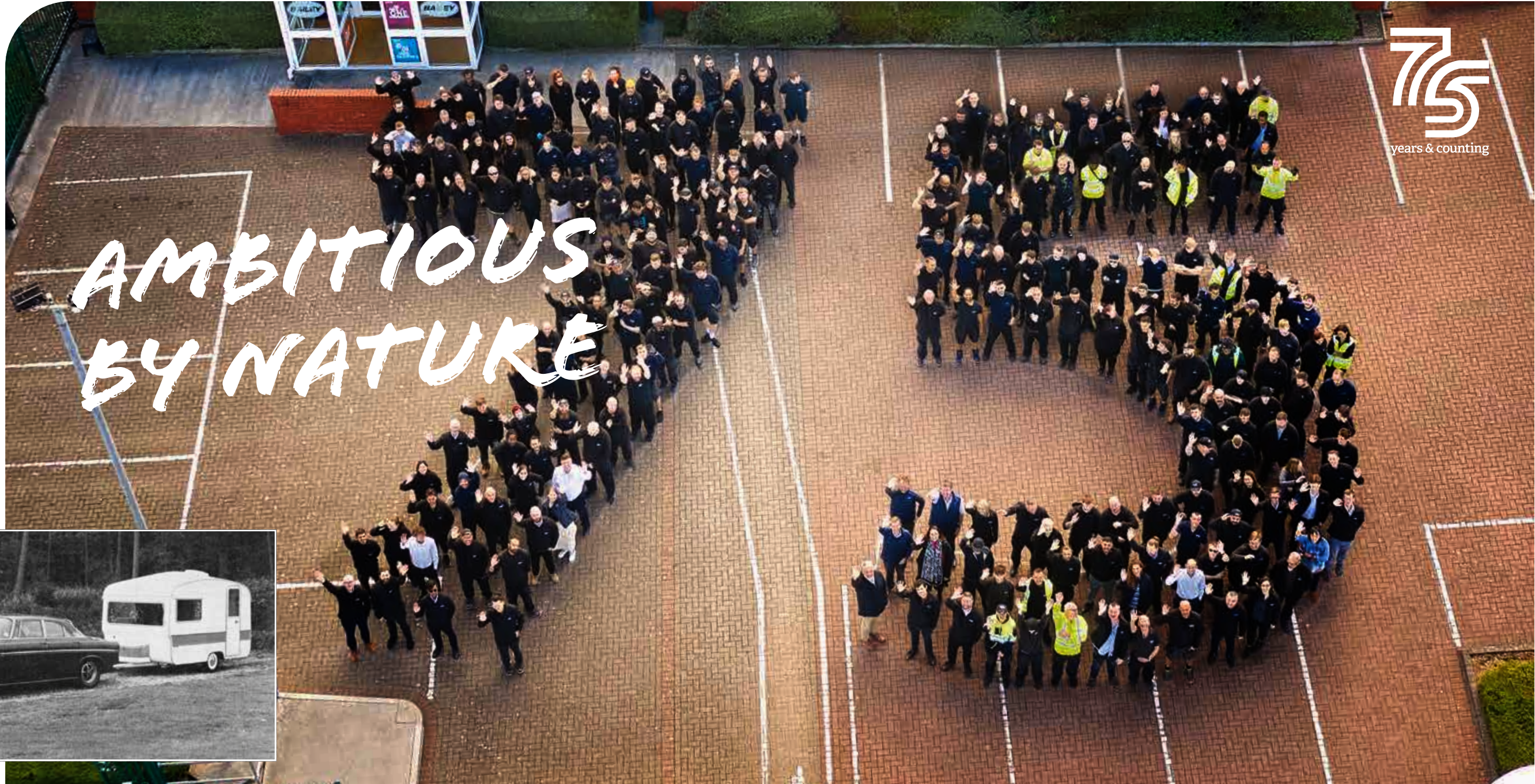

# Our road to sustainability

Caravans and motorhomes have long provided environmentally friendly holidays for people who have an appreciation for the great outdoors and who want to see it remain protected.

At Bailey, we remain committed to playing our part in this process by reducing the environmental footprint of our operations and striving to make our leisure vehicle products as sustainable as possible. Over recent years we have undertaken a range of initiatives designed to reduce our impact on the environment, covering our products, our sites and our culture.

In 2022 we signed up to the Woodland Trust Woodland Carbon Scheme to help reduce the environmental impact of our operations and at the same time boost biodiversity through the planting of trees. Consequently, when customers now purchase new Bailey caravans or motorhomes, we are planting trees to help offset the carbon emissions generated when we manufacture them.

To learn more about this and the other changes we are making to become a greener business visit the Sustainable Manufacturing page on our website or scan the QR code below.





# Made in Bristol

We've been proud to call South Bristol home since 1948. Martin Bailey designed and built the first Bailey caravan in his garage, just a stone's throw from the South Liberty Lane site that now houses our 14.5-acre production facility.

We think of ourselves as one big family. Most of us live nearby and have been part of Bailey for a long time (ten years is the average length of service).

From our joiners and electricians to our designers and fabricators, we have the skills, expertise and experience to build a complex range of caravans and motorhomes, all in the same plant – and all by hand.

For more information, head to our 'Manufacturing in Bristol' page on the Bailey site or scan the QR code below.



# What goes into The Nation's Favourite?

It all started with a simple question: "Is there a better way?"

Leisure vehicle design and construction was stagnant for over 30 years, until we developed Alu-Tech and changed everything. Alu-Tech is a completely new approach to bodyshell construction. Using a unique interlocking aluminium framework to clamp the body panels together, Bailey created a shell that is more robust and durable than anything else on the market.

By significantly reducing the number of external joints and fixing points and using timber-free components in the upper bodyshell panels, we are able to provide greater protection against the elements. Thicker, better-insulated panels, cloaked in impact resistant GRP (Glass Reinforced Plastic), hugely improve the thermal performance of the bodyshell, for genuine four-season performance. All this with no increase in weight or cost. Turns out there really is a better way.



**3 year** transferable manufacturer's components warranty\*

**6 year** transferable bodyshell integrity warranty\*

Access to aftercare team

\*Terms and conditions apply. Please visit [baileyofbristol.co.uk/warranties-servicing](http://baileyofbristol.co.uk/warranties-servicing) for more information.



Since Alu-Tech first hit the road ten years ago, we've built more than 75,000 leisure vehicles using Alu-Tech technology. To learn more about the unique features and benefits of Alu-Tech, head to the Bailey website.

- 1 Polystyrene core
- 2 Composite plastic extrusion
- 3 Alu-Tech rail
- 4 Structural fixing bracket
- 5 Alu-Tech rail insulation
- 6 GRP (Glass Reinforced Plastic) outer and inner skin

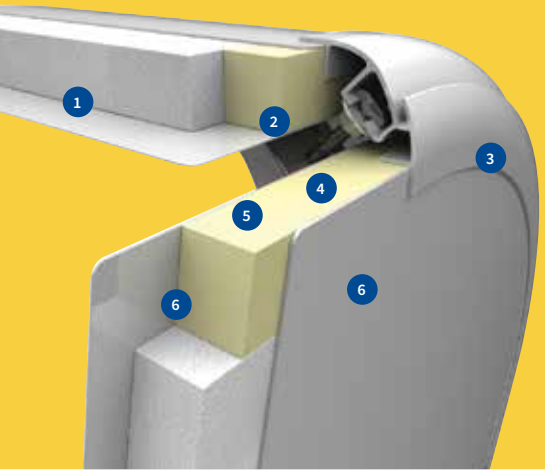



## Tested to the limit

**From desert dust to Arctic ice, we put our caravans through their paces, so they're at their best on the roads of Great Britain – and beyond.**

Good enough simply isn't good enough. It's why we go to extreme lengths to make sure our caravans can perform, whatever's thrown their way. It's only through rigorous testing that we're satisfied our products are ready for the road. Every new range goes through test conditions that push the limits of what a caravan is likely to encounter in its lifetime.

Like our cold chamber testing, which goes down to -15°C to get the best possible results in thermal insulation with the help of our heating system partners.

If something's not up to the job, we go back to the drawing board until it is. That way, when our products hit the road, we know every single one is the best it can be. See how else we take our testing to the limit on our website and learn more about our Bailey Big Adventures by scanning the QR code.



## Go anywhere, do everything

Cold chambers and test trucks are one thing, but few things beat getting out there properly.

In 2015, we took two caravans on a 3,500-mile journey through the Australian Outback. During the two-week trip, they stood up to everything the elements could throw at them, proving they could hold their own in even the toughest conditions.

In 2017, we embarked on another marathon endurance test; this time with two caravans and a motorhome, on a 5,000-mile trip to Northern Finland – and well inside the Arctic Circle. Conditions couldn't have been more different than the Red Centre of Australia, but once again the vehicles took everything in their stride.

The successes of these adventures really whet our appetite. So, we decided to embark on a third: 21 countries in 21 days, across two continents – without a rest. From Bristol to Istanbul, we're proud to say the vehicles were more than capable and eager for more – even if we were well in need of a break.







Comfortable & capable

COMFY IN ALL  
THE RIGHT  
PLACES



## Get to know Phoenix+

Phoenix+ now has a six-strong range, so there's plenty of choice to meet your needs – and it makes joining the Bailey family more accessible than ever.

Inside and out, Phoenix+ is spacious, comfortable and well-equipped with practical design features and a touch of luxury, all in a robust and lightweight four-season package. Wherever you choose to make your holiday, Phoenix+ is the perfect base – anywhere and everywhere.

6 Models

2-5 Berths

### Favourite facts

- Spacious yet lightweight design accessible to a wide range of tow vehicles
- AL-KO stabiliser hitch and TUV tested 14" alloy wheels for added security
- Four season all weather sustainability with Truma Combi blown air heating system
- Light and airy interiors featuring a vertical opening front skylight
- Efficient 12V task and mood lighting
- Thoughtful selection of 230v power sockets and USB points
- Status 570 telescopic directional digital television aerial
- Thetford K-Series combined oven, grill and hob
- Dometic 106 litre refrigerator
- Branded 700 watt integrated microwave oven with non-moving ceramic hot plate



## Key features

- 1 Vertical front skylight
- 2 'Chesham' soft furnishings with co-ordinating curtains and two scatter cushions
- 3 Bailey 'Light Oak' furniture finish
- 4 Two-drawer front chest with slide out occasional table and soft close drawers
- 5 Low level storage cupboard beneath front chest
- 6 Conventional cushion construction with fully sprung knee rolled base cushions and square back rests
- 7 Dual finish Italian design overhead curved locker doors with 'canvas' textured contrasting stripe and over-locker LED lighting
- 8 Bespoke caravan bedding sets to co-ordinate with caravan soft furnishings (cost option)



Scan to see  
the full range



Model 640

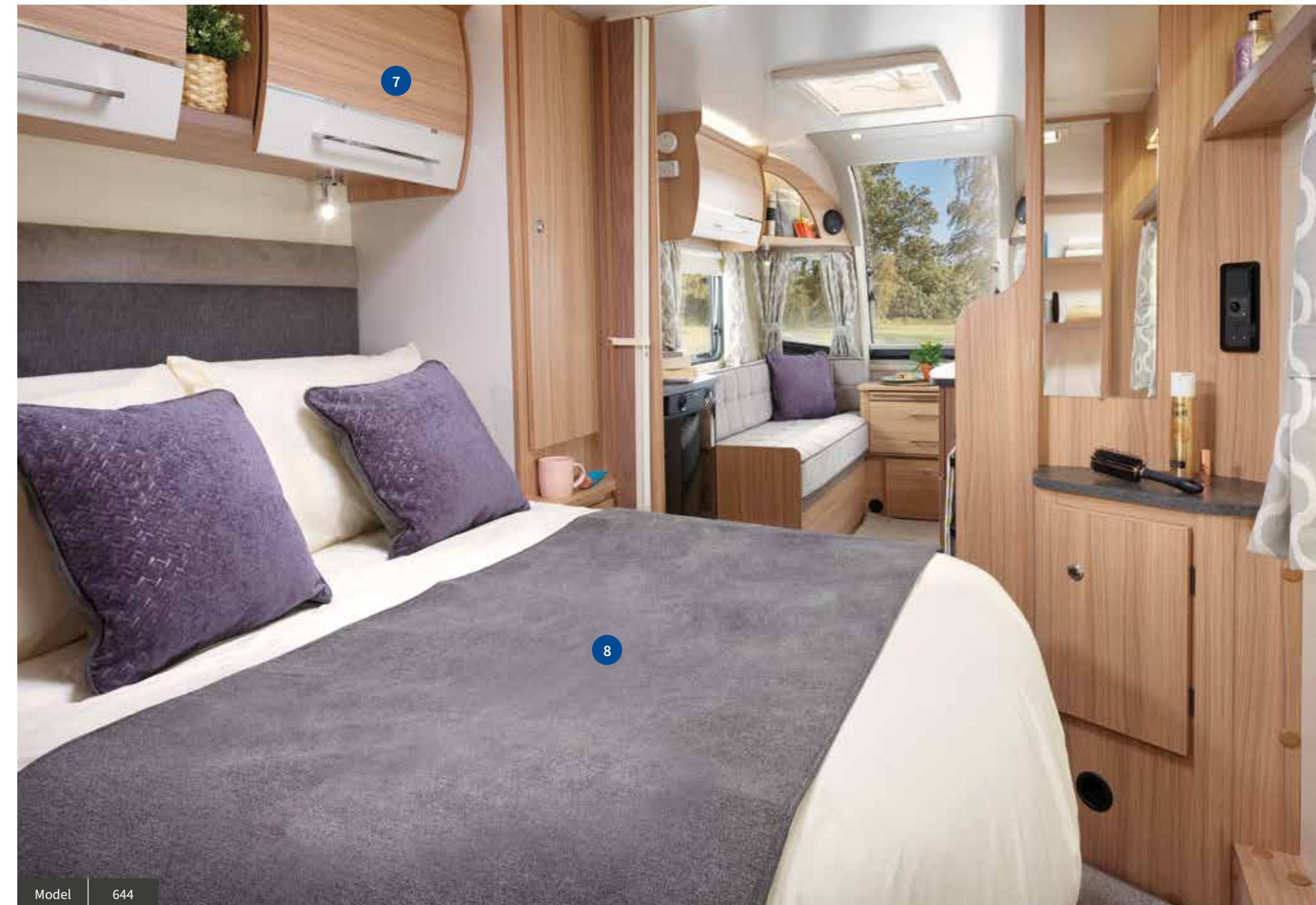

Model 644





Model 644



Scan to find your nearest retailer

- 1 Full width backlit washroom mirror (model specific)
- 2 Stainless steel round kitchen sink with concealed fixings, mixer tap and drainer
- 3 Drop down hob cover worktop



Model 644

- 4 White gloss shower cubicle with bi-fold partition door and integral lighting
- 5 'Hazelnut' loose fit drop in carpets
- 6 Branded DAB radio with USB connection point and Bluetooth capability



Model 640



Model 640



Model 640



Model 420







Scan to see  
the full range



420	2 ↑
Internal Length	4.032m/13'2"
Shipping Length	5.564m/18'3"
Overall Width	2.212m/7'3"
Overall Height	2.624m/8'7"
Internal Headroom	1.960m/6'5"
Awning Size	857cm
Tyre Sizes	195/70R14
MTPLM	1146kg
MRO	1029kg
Total User Payload	117kg

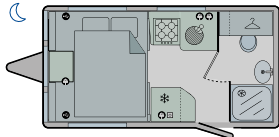
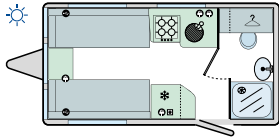

#### Bed Sizes

Front Double	1.88m x 1.47m/6'2" x 4'10"
Front N/S Single	1.88m x 0.64m/6'2" x 2'1"
Front O/S Single	1.88m x 0.64m/6'2" x 2'1"



440	4 ↑
Internal Length	5.351m/17'7"
Shipping Length	6.882m/22'7"
Overall Width	2.212m/7'3"
Overall Height	2.624m/8'7"
Internal Headroom	1.960m/6'5"
Awning Size	995cm
Tyre Sizes	185/R14C
MTPLM	1347kg
MRO	1197kg
Total User Payload	150kg

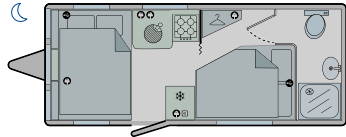
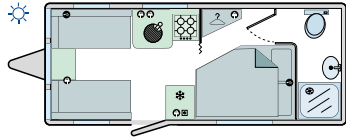

#### Bed Sizes

Front Double	1.88m x 1.10m/6'2" x 3'7"
Front N/S Single	1.50m x 0.64m/4'11" x 2'1"
Front O/S Single	1.50m x 0.64m/4'11" x 2'1"
Rear Fixed Double	1.90m x 1.32m/6'3" x 4'4"



642	4 ↑
Internal Length	5.841m/19'2"
Shipping Length	7.369m/24'2"
Overall Width	2.212m/7'3"
Overall Height	2.624m/8'7"
Internal Headroom	1.960m/6'5"
Awning Size	1035cm
Tyre Sizes	185/R14C
MTPLM	1410kg
MRO	1255kg
Total User Payload	155kg

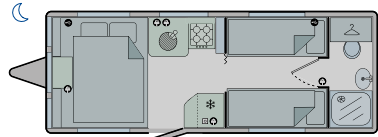
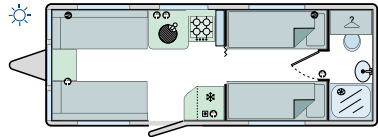

#### Bed Sizes

Front Double	1.88m x 1.40m/6'2" x 4'7"
Front N/S Single	1.81m x 0.64m/5'11" x 2'1"
Front O/S Single	1.81m x 0.64m/5'11" x 2'1"
Rear N/S Fixed Single	1.90m x 0.69m/6'3" x 2'3"
Rear O/S Fixed Single	1.90m x 0.69m/6'3" x 2'3"



644	4 ↑
Internal Length	5.841m/19'2"
Shipping Length	7.369m/24'2"
Overall Width	2.212m/7'3"
Overall Height	2.624m/8'7"
Internal Headroom	1.960m/6'5"
Awning Size	1035cm
Tyre Sizes	185/R14C
MTPLM	1395kg
MRO	1240kg
Total User Payload	155kg

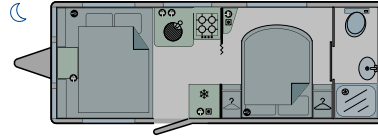
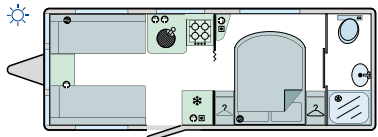

#### Bed Sizes

Front Double	1.88m x 1.40m/6'2" x 4'7"
Front N/S Single	1.81m x 0.64m/5'11" x 2'1"
Front O/S Single	1.81m x 0.64m/5'11" x 2'1"
Rear Fixed Double	1.89m x 1.39m/6'2" x 4'7"



640	4 ↑
Internal Length	5.841m/19'2"
Shipping Length	7.369m/24'2"
Overall Width	2.212m/7'3"
Overall Height	2.624m/8'7"
Internal Headroom	1.960m/6'5"
Awning Size	1035cm
Tyre Sizes	185/R14C
MTPLM	1411kg
MRO	1257kg
Total User Payload	155kg

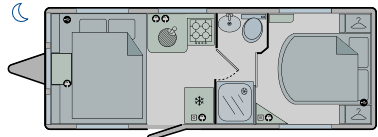
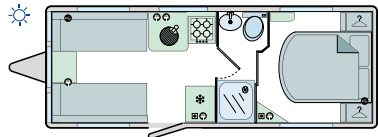

#### Bed Sizes

Front Double	1.88m x 1.40m/6'2" x 4'7"
Front N/S Single	1.81m x 0.64m/5'11" x 2'1"
Front O/S Single	1.81m x 0.64m/5'11" x 2'1"
Rear Fixed Double	1.89m x 1.39m/6'2" x 4'7"



650	5 ↑
Internal Length	5.841m/19'2"
Shipping Length	7.369m/24'2"
Overall Width	2.212m/7'3"
Overall Height	2.624m/8'7"
Internal Headroom	1.960m/6'5"
Awning Size	1035cm
Tyre Sizes	185/R14C
MTPLM	1409kg
MRO	1244kg
Total User Payload	165kg

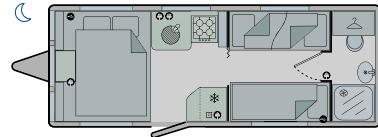
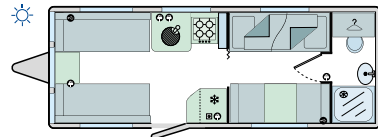

#### Bed Sizes

Front Double	1.88m x 1.40m/6'2" x 4'7"
Front N/S Single	1.81m x 0.64m/5'11" x 2'1"
Front O/S Single	1.81m x 0.64m/5'11" x 2'1"
Rear N/S Single	1.88m x 0.69m/6'2" x 2'3"
Rear O/S Fixed Bunks	1.86m x 0.66m/6'1" x 2'2"

A tolerance in the MRO has been allowed for in the calculations of Payload Margins. The awning length measurement shown is to be interpreted as a guide only and an enquiry should be made to individual awning manufacturers as to the correct size. Bed sizes are measured at the widest point of the bed.



## Where to buy your Bailey

The next step is to find out a little bit more. We have a network of approved Retailers across the country, who we choose to work with because of their expertise. And, like us, they love to get out there and Go Bailey! themselves.

Once you've found your Retailer, you can explore the ranges and models first-hand, along with pre-owned Bailey caravans,\* and find out which one is 'the one'. The Retailer will be on-hand to guide you through your decision and will be happy to talk through finance options, if you need them. Scan the QR code below to find your nearest retailer.

### The Bailey warranty

Your new Bailey comes with the peace of mind of our manufacturer's warranty. Your caravan's bodyshell is covered with a six-year integrity warranty, while other parts and components are covered for up to three years.\*\*



\*Subject to availability.  
\*\*Terms and conditions apply. Please refer to [baileyofbristol.co.uk](http://baileyofbristol.co.uk) for more details.

# JOIN THE CLUB



Once you're out on the road with your Bailey, you're already part of an exclusive club. So why not go one step further and join the real thing?

The Bailey Owners Club is here to help you get the most from your Bailey caravan or motorhome. Completely independent from Bailey of Bristol, there are members all over the world – and there's even a 'Little Bees' club for younger caravanners.

Membership is full of benefits. You'll be invited to weekend events and rallies across the UK, often at exclusive venues, while enjoying discounts on longer holidays in the UK and abroad – as well as online discounts at PRIMA Leisure, of course. You'll even have the chance to come and tour the Bailey factory, and meet the people behind Bailey.

Scan the QR code below for more information regarding the Bailey Owners Club.





## Exceptional aftercare and accessories

Once you're the proud owner of a Bailey caravan, you want to get the best out of it. Whether you need a replacement part, a must-have luxury, or upgrading to the latest tech, make PRIMA Leisure your first stop for all things Bailey.

As part of the Bailey family, the PRIMA team of experts is proud to offer first-class aftercare service and advice to Bailey owners across the UK.

With over 25,000 original parts and accessories available at the click of a button, PRIMA is here to help you 'Go Bailey'!



Browse the  
PRIMA website

25,000+

Products available  
to browse



Shop 24 hours a day  
7 days a week



Bailey experts on-hand  
to help



Deliver directly to you  
while on holiday (UK only)



Genuine OEM parts  
and quality accessories





Join our community



[baileyofbristol.co.uk](http://baileyofbristol.co.uk)



This brochure does not constitute an offer by Bailey Caravans Ltd (Bailey). Bailey reserves the right to alter specifications and prices as market and supply conditions demand. Your Bailey Retailer will confirm all specification details prior to you making your purchasing decision. E. & O. E. Bailey Retailers sell our products of their own choice and not as agents of Bailey. Accordingly they have no authority to bind Bailey or to make any representation or undertaking whatsoever on behalf of Bailey. All household items illustrated in this brochure are used to enhance photography and are for display purposes only. They are not supplied with your touring caravan. Photographic colour reproduction is subject to the limitations of the production process. Printed February 2023.

**Designed and produced by:** saintnicks

**Photography:** Alan Bond, assisted by Henry Howard.

**Photography locations:**

**Alicanto Grande:** Cheddar Mendip Heights Camping and Caravanning Club Site

[www.campingandcaravanningclub.co.uk](http://www.campingandcaravanningclub.co.uk)

**Pegasus Grande SE:** Southfield Farm CL, Malmesbury, Wiltshire [www.southfieldfarm.co.uk](http://www.southfieldfarm.co.uk)

**Unicorn:** Little Meadow Campsite, Watermouth, Ilfracombe, Devon [www.littlemeadow.co.uk](http://www.littlemeadow.co.uk)

**Phoenix+:** Leigh Court, Abbots Leigh, Bristol [www.leighcourt.co.uk](http://www.leighcourt.co.uk), and Clevedon Beach

**Discovery:** Pwllyn Farm Camping, Libanus, Powys