

PRESENTATION OF THE P700C

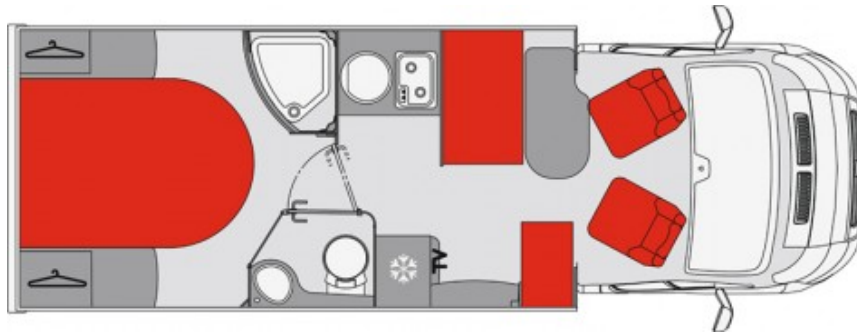

P700C ADVANTAGES

- > Straight kitchen with removable worktop
- > Large transverse storage
- > Lowered storage for easier loading
- > L-shaped living
- > Extra Low-profile 2,75 m

PRACTICAL INFORMATION



Length
6,95 m



Width
2,30 m



Seated places
4



Sleeping places
2+1 en option



Eating places
5



Acces side
compartment
1650 L



Payload
Essentiel : 660 kg
Sensation : 620 kg



MTPLM (Gross
Weight)
3500 kg



Mass of both (PTRA)
6000 kg



Motor engine
130 Multijet

●●● ESSENTIEL	●●● SENSATION ESSENTIEL
CAB	
<ul style="list-style-type: none"> > Manual cabin air conditioning > Cab carpet > Cab curtains with suction grips > Ready for radio (antenna + speaker prewiring in cabin and bedroom) > Cab seats with covers, swivel bases height adjustable > Central locking cab doors electric windows 	<ul style="list-style-type: none"> > Bluetooth CD Tuner (USB / AUX) with cabin speakers > Aluminium dashboard finish > Front and side sliding cab curtains
HEATING	
<ul style="list-style-type: none"> > 4000W Combi4 TRUMA ® heating / boiler > Cabling for solar panel / automatic satellite antenna > TRUMA ® Crash Sensor simple regulator used while driving 	<ul style="list-style-type: none"> > 6000W Combi6 TRUMA ® heating / boiler > Automatic TRUMA ® Crash Sensor regulator automatic gas bottle selection ; used while driving
LOUNGE	
<ul style="list-style-type: none"> > Seat foam high density > Coloured curtains tapes > Height adjustable headrest > Living room with straight shape sofa (except P710P/P716P) > SkyDome on low profile with pull-down bed > Adjustable TV support and power supply > 620 x 420 Panoramic sunroof 	<ul style="list-style-type: none"> > 4 decorative cushions coordinated to the curtains > Upholstery finish at the bottom of the living area > L-shaped living room and central table > SkyDome on low profile with pull-down bed > Indirect dimmer switch
ENTRY	
<ul style="list-style-type: none"> > Opaque cell door 	<ul style="list-style-type: none"> > Retractable electric entrance step > Control panel with digital display ; inside/outside temperature display > 2 points glazed cell door, with central locking and fly-screen
KITCHEN	
<ul style="list-style-type: none"> > Kitchen credence > Indirect lighting under the kitchen worktop > Saucepan rack with end travel shock absorbers > Round stainless steel sink with cover > 2 or 3 burners stainless steel cooker with cover > Spice rack > 230V, 12V and USB Plugs > Automatic fridge in litres except P600P-G600P/G-G600P/G (105L) 	<ul style="list-style-type: none"> > Backlighting bar in the kitchen > Backlighting credence > Extractor fan with LED lighting > Integrated dustbin
OUTSIDE	
<ul style="list-style-type: none"> > 2.3L 130 Multijet > ABS anti-lock braking wheels > Structure assembly on aluminium rail > Double glazing window on alu frame with blackout blind fly-screen > White aluminium side skirts > Storage location for two 13 kg gas bottles > Aluminium exterior sides > External LED lighting > Daytime running lights > LED rear brake-lights 	<ul style="list-style-type: none"> > Sensation exterior decor > Waste watertank frost protection

- > Thermal acoustic insulation Styrofoam (28mm sides and roof / 35 mm floor)
- > Repair wheel kit
- > Front bumper painted in body color
- > Polyester roof with hail protection
- > Polyester coating under the floor
- > Electric defrosting rear-view mirrors wide angle blind spot
- > Structure using rot-resistant battens

SHOWER AND WC

- > Shower separated by a door
- > Shower Column with soap holder
- > Occulting skylight / fly-screen
- > Hooks, toilette roll holder, tower holder
- > 230v plugs
- > Toilet with wheeled removable module

- > LED direct lighting
- > Wardrobe rod foldable

BEDROOM

- > Bultex mattress foam
- > 230V plug
- > Slatted base

- > Additional sleeping facilities between twin beds
- > Light in the wardrobe
- > Manual headboard on island bed
- > Manual headboard on twin beds

STORAGE AREA

- > 2 storage boxes + secure rails + 1 point lighting + 230V socket
- > Manual height adjustable garage on Garage bed